



GENERATOR SET

| | | |
|--------------|---------|---------|
| Standby | kVA | 50 |
| | kW | 40 |
| Prime | kVA | 45 |
| | kW | 36 |
| Engine Speed | r.p.m | 1500 |
| Voltage | V | 230/400 |
| Power Factor | Cos Phi | 0,8 |

CERTIFICATES

◆ CE Certificate

- ◆ 2006/42/EC Machinery Safety Directive
- ◆ 2014/30/EU Electromagnetic Compatibility Directive
- ◆ 2014/35/EU Low Voltage Directive
- ◆ 2000/14/EC By Equipment Used in the Open Field
- ◆ Regulation on Noise Emission in the Created Environment
- ◆ EN 12100:2010, TS EN 60201-1, EN 55011, EN 61000-6-4, EN 61000-4-11, EN 61000-4-8, EN 610000-4-5, EN 610000-4-2, EN 610000-4-2, EN 12601, TS ISO 8528-1-12

◆ TSE Certificate of Conformity to Turkish Standards

- ◆ TS EN 60034-1:2010
- ◆ TS ISO 8528-5
- ◆ TS ISO 8528-4
- ◆ TSE Service Place Qualification Certificate

◆ ISO 9001:2015 Quality Management System Certificate

- ◆ ISO 14001:2015 Environmental Management System Certificate
- ◆ OHSAS 18001:2007 Occupational Health and Safety Management
- ◆ ISO 10002:2014 Customer Satisfaction Management. System Cer.
- ◆ TS ISO/IEC 25051:2015 Software Engineering Certificate
- ◆ Republic of Turkey Ministry of Trade, After Sales Services
- ◆ 1500 hl Salt Water Test Certificate TS EN ISO/IEC 17025
- ◆ Domestic Goods Certificate
- ◆ Manufacturing Competence Certificate
- ◆ Industrial Registry Certificate
- ◆ Capacity Report
- ◆ Trademark Registration Certificate
- ◆ UKR-Sepro
- ◆ Perkins EM Manufacturer Certificate



MOTOR



| | | |
|-------------------------------------|-------------|-------------------|
| Net Motor Output Power | <i>kW</i> | 41 |
| Standby Output Power | <i>kW</i> | 46 |
| Brand | | Perkins |
| Model | | 1103A-33TG1 |
| Engine Type | | 4 Stroke - Diesel |
| Spray Pattern | | Direct Injection |
| Suction Type | | Turbo Charge |
| Number of Cylinders | | 3 |
| Cylinder Diameter and Stroke | <i>mm</i> | 105 x 127 |
| Cylinder Volume | <i>L</i> | 3,3 |
| Cooling Type | | Water Cooling |
| Compression Ratio | | 17.25:1 |
| Fuel Consumption at Stand by Load | <i>l/h</i> | 12 |
| 100% Fuel Consumption at Prime Load | <i>l/h</i> | 10,7 |
| 75% Fuel Consumption at Prime Load | <i>l/h</i> | 8,2 |
| 50% Fuel Consumption at Prime Load | <i>l/h</i> | 5,7 |
| Total Oil Capacity | <i>L</i> | 8,3 |
| Total Cooling Capacity | <i>L</i> | 10,2 |
| Governor Type | <i>Type</i> | Electronic |

ALTERNATOR



| | | |
|---------------------------------|-------------|--------------|
| Brand | | Maranello |
| Model | | M50 |
| Output Voltage | <i>V</i> | 230/400 |
| Frequency | <i>HZ</i> | 50 |
| Automatic Voltage Regulation | $\pm\%$ | 1 |
| Standby Power | <i>kVA</i> | 50,1 |
| Continuous Use Power | <i>kVA</i> | 46 |
| Power Factor | <i>Cosφ</i> | 0,8 |
| Number of Cables | | 12 |
| Winding Pitch | | 2/8 |
| Protection Class | | IP23/H |
| Warning System | | Self-excited |
| AVR Model | | SX460 |
| Performance - PF 0.8 / 75% Load | <i>%</i> | 88,5 |

DIMENSIONS

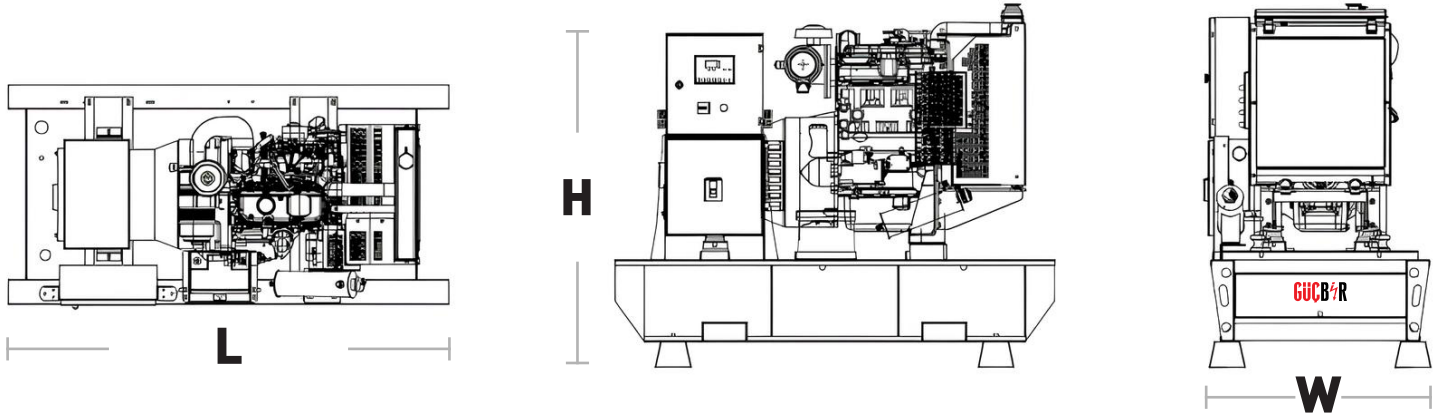

WITHOUT CABIN

| | | |
|-------------------------------------|----|---------------|
| Length (L) x Width (W) x Height (H) | mm | 1770x850x1440 |
| Weight | kg | 775 |
| Fuel Tank Capacity | lt | 135 |

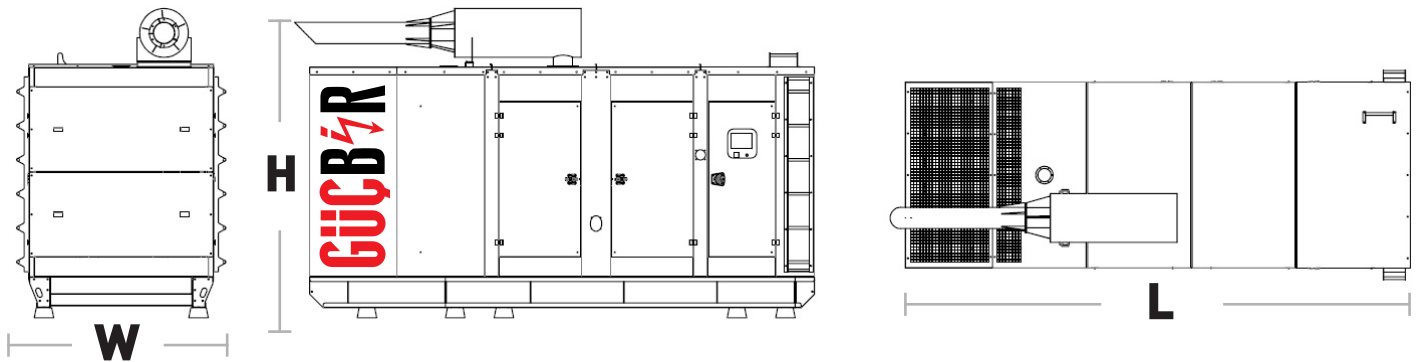

WITH CANOPY

| | | |
|-------------------------------------|----|---------------|
| Length (L) x Width (W) x Height (H) | mm | 2225x950x1660 |
| Weight | kg | 1220 |
| Fuel Tank Capacity | lt | 135 |

SOUND ISOLATION CABINET FEATURES

- ◆ Container and modular cabin production
- ◆ 65-75db. sound insulation
- ◆ Anti-vibration system
- ◆ Grilles for cooling and air circulation
- ◆ Special attachments for easy transportation
- ◆ Insulated transparent cover for easy access to the control cabinet
- ◆ Hidden exhaust
- ◆ Emergency stop button

CONTROL PANEL



D500 MK3



- ◆ 4-band GPRS modem (optional)
- ◆ USB Device
- ◆ RS-232 (2400-57600baud)
- ◆ J1939-CANBUS
- ◆ Geolocation with GSM
- ◆ GPS support (RS-232)

- ◆ Internet Centric Monitoring
- ◆ Send SMS messages (optional)
- ◆ Emailing (optional) Free PC software
- ◆ re: Rainbow Plu
- ◆ Modbus RTU

ATS PANEL

Güçbir Generator offers robust, versatile and compact solutions to transfer basic loads and electrical distribution systems from one power source to another with ATS panels. Güçbir's contactors, motorized switches and changeoverbased ATSs range from 40A to 6300 A and can be supplied externally for various applications. Also available internally switchgear inside the ATS panels, which can be supplied by ABB, SIEMENS, SCHNEIDER, GE, LS, HYUNDAI, TELERGON, SOCOMEC and ANDELI are internationally recognized trademarks.



OPTIONAL FEATURES

- ◆ Medium voltage alternator,
- ◆ Remote radiator applications
- ◆ Automatic refueling system
- ◆ Fuel tank, oil pan, instrument panel, alternator, coil heaters,
- ◆ Alternator with dual AVR and PMG
- ◆ Synchronization systems, Generator output switch,
- ◆ Mains-Generator transfer switches,
- ◆ Cabins in volumes suitable for special insulation demands
- ◆ Seismic solutions
- ◆ Trailer
- ◆ Remote monitoring
- ◆ SMPS 12/24V 10A

CONTROL PANEL

- ◆ Deepsea Control Devices
- ◆ Emko Control Devices
- ◆ ComAp Control Devices
- ◆ DEIF Control Devices

