



GENERATOR SET

Standby	kVA	72
	kW	57,6
Prime	kVA	65
	kW	52
Engine Speed	r.p.m	1500
Voltage	V	230/400
Power Factor	Cos Phi	0,8

CERTIFICATES

◆ CE Certificate

- ◆ 2006/42/EC Machinery Safety Directive
- ◆ 2014/30/EU Electromagnetic Compatibility Directive
- ◆ 2014/35/EU Low Voltage Directive
- ◆ 2000/14/EC By Equipment Used in the Open Field
- ◆ Regulation on Noise Emission in the Created Environment
- ◆ EN 12100:2010, TS EN 60201-1, EN 55011, EN 61000-6-4, EN 61000-4-11, EN 61000-4-8, EN 610000-4-5, EN 610000-4-2, EN 610000-4-2, EN 12601, TS ISO 8528-1-12

◆ TSE Certificate of Conformity to Turkish Standards

- ◆ TS EN 60034-1:2010
- ◆ TS ISO 8528-5
- ◆ TS ISO 8528-4
- ◆ TSE Service Place Qualification Certificate

◆ ISO 9001:2015 Quality Management System Certificate

- ◆ ISO 14001:2015 Environmental Management System Certificate
- ◆ OHSAS 18001:2007 Occupational Health and Safety Management
- ◆ ISO 10002:2014 Customer Satisfaction Management. System Cer.
- ◆ TS ISO/IEC 25051:2015 Software Engineering Certificate
- ◆ Republic of Turkey Ministry of Trade, After Sales Services
- ◆ 1500 hl Salt Water Test Certificate TS EN ISO/IEC 17025
- ◆ Domestic Goods Certificate
- ◆ Manufacturing Competence Certificate
- ◆ Industrial Registry Certificate
- ◆ Capacity Report
- ◆ Trademark Registration Certificate
- ◆ UKR-Sepro
- ◆ Perkins EM Manufacturer Certificate



MOTOR



Net Motor Output Power	<i>kW</i>	58
Standby Output Power	<i>kW</i>	64
Brand		Perkins
Model		1104A-44TG1
Engine Type		4 Stroke - Diesel
Spray Pattern		Direct Injection
Suction Type		Turbo Charge
Number of Cylinders		4
Cylinder Diameter and Stroke	<i>mm</i>	105 x 127
Cylinder Volume	<i>L</i>	4,4
Cooling Type		Water Cooling
Compression Ratio		17.25:1
Fuel Consumption at Stand by Load	<i>l/h</i>	16,2
100% Fuel Consumption at Prime Load	<i>l/h</i>	14,8
75% Fuel Consumption at Prime Load	<i>l/h</i>	11,2
50% Fuel Consumption at Prime Load	<i>l/h</i>	8
Total Oil Capacity	<i>L</i>	8
Total Cooling Capacity	<i>L</i>	13
Governor Type	<i>Type</i>	Electronic

ALTERNATOR



Brand		Maranello
Model		M75
Output Voltage	<i>V</i>	230/400
Frequency	<i>HZ</i>	50
Automatic Voltage Regulation	$\pm\%$	1
Standby Power	<i>kVA</i>	73,6
Continuous Use Power	<i>kVA</i>	67,5
Power Factor	<i>Cosφ</i>	0,8
Number of Cables		12
Winding Pitch		2/10
Protection Class		IP23/H
Warning System		Self-excited
AVR Model		SX460
Performance - PF 0.8 / 75% Load	<i>%</i>	91

DIMENSIONS

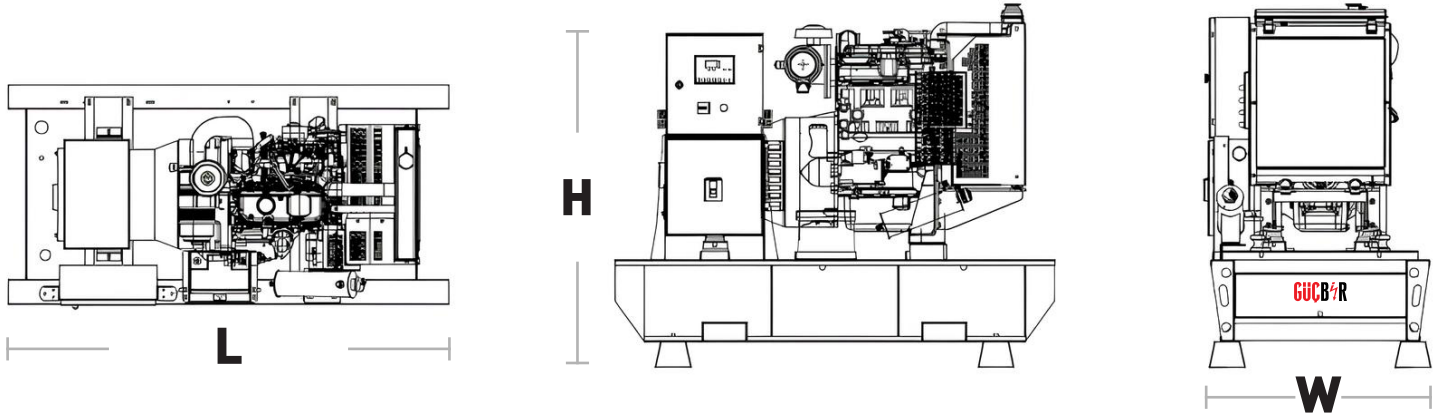

WITHOUT CABIN

Length (L) x Width (W) x Height (H)	mm	1900x900x1610
Weight	kg	1020
Fuel Tank Capacity	lt	220

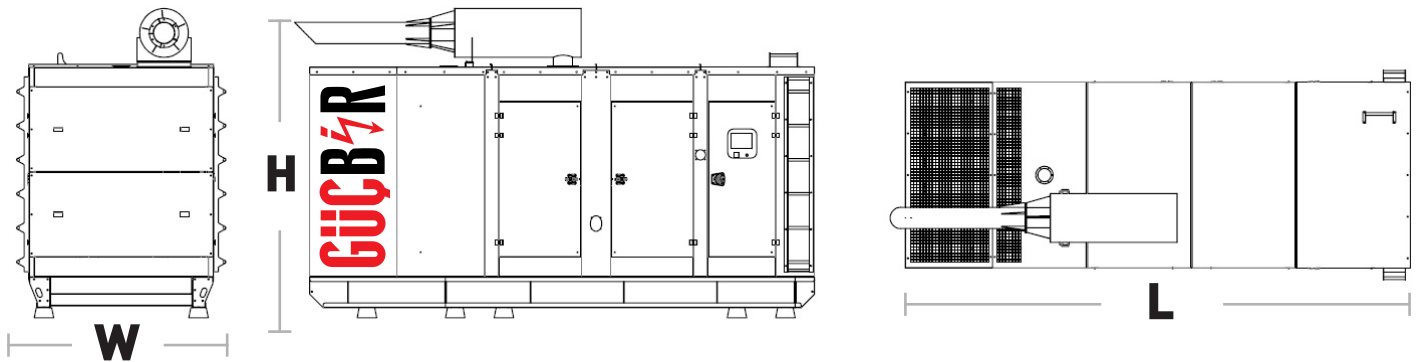

WITH CANOPY

Length (L) x Width (W) x Height (H)	mm	2440x1000x1860
Weight	kg	1440
Fuel Tank Capacity	lt	220

SOUND ISOLATION CABINET FEATURES

- ◆ Container and modular cabin production
- ◆ 65-75db. sound insulation
- ◆ Anti-vibration system
- ◆ Grilles for cooling and air circulation
- ◆ Special attachments for easy transportation
- ◆ Insulated transparent cover for easy access to the control cabinet
- ◆ Hidden exhaust
- ◆ Emergency stop button

CONTROL PANEL



D500 MK3



- ◆ 4-band GPRS modem (optional)
- ◆ USB Device
- ◆ RS-232 (2400-57600baud)
- ◆ J1939-CANBUS
- ◆ Geolocation with GSM
- ◆ GPS support (RS-232)

- ◆ Internet Centric Monitoring
- ◆ Send SMS messages (optional)
- ◆ Emailing (optional) Free PC software
- ◆ re: Rainbow Plu
- ◆ Modbus RTU

ATS PANEL

Güçbir Generator offers robust, versatile and compact solutions to transfer basic loads and electrical distribution systems from one power source to another with ATS panels. Güçbir's contactors, motorized switches and changeoverbased ATSs range from 40A to 6300 A and can be supplied externally for various applications. Also available internally switchgear inside the ATS panels, which can be supplied by ABB, SIEMENS, SCHNEIDER, GE, LS, HYUNDAI, TELERGON, SOCOMEC and ANDELI are internationally recognized trademarks.



OPTIONAL FEATURES

- ◆ Medium voltage alternator,
- ◆ Remote radiator applications
- ◆ Automatic refueling system
- ◆ Fuel tank, oil pan, instrument panel, alternator, coil heaters,
- ◆ Alternator with dual AVR and PMG
- ◆ Synchronization systems, Generator output switch,
- ◆ Mains-Generator transfer switches,
- ◆ Cabins in volumes suitable for special insulation demands
- ◆ Seismic solutions
- ◆ Trailer
- ◆ Remote monitoring
- ◆ SMPS 12/24V 10A

CONTROL PANEL

- ◆ Deepsea Control Devices
- ◆ Emko Control Devices
- ◆ ComAp Control Devices
- ◆ DEIF Control Devices

