



### GENERATOR SET

Standby	kVA	44
	kW	35,2
Prime	kVA	40
	kW	32
Engine Speed	r.p.m	1500
Voltage	V	230/400
Power Factor	Cos Phi	0,8

### CERTIFICATES

#### ◆ CE Certificate

- ◆ 2006/42/EC Machinery Safety Directive
- ◆ 2014/30/EU Electromagnetic Compatibility Directive
- ◆ 2014/35/EU Low Voltage Directive
- ◆ 2000/14/EC By Equipment Used in the Open Field
- ◆ Regulation on Noise Emission in the Created Environment
- ◆ EN 12100:2010, TS EN 60201-1, EN 55011, EN 61000-6-4, EN 61000-4-11, EN 61000-4-8, EN 610000-4-5, EN 610000-4-2, EN 610000-4-2, EN 12601, TS ISO 8528-1-12

#### ◆ TSE Certificate of Conformity to Turkish Standards

- ◆ TS EN 60034-1:2010
- ◆ TS ISO 8528-5
- ◆ TS ISO 8528-4
- ◆ TSE Service Place Qualification Certificate

#### ◆ ISO 9001:2015 Quality Management System Certificate

- ◆ ISO 14001:2015 Environmental Management System Certificate
- ◆ OHSAS 18001:2007 Occupational Health and Safety Management
- ◆ ISO 10002:2014 Customer Satisfaction Management. System Cer.
- ◆ TS ISO/IEC 25051:2015 Software Engineering Certificate
- ◆ Republic of Turkey Ministry of Trade, After Sales Services
- ◆ 1500 hl Salt Water Test Certificate TS EN ISO/IEC 17025
- ◆ Domestic Goods Certificate
- ◆ Manufacturing Competence Certificate
- ◆ Industrial Registry Certificate
- ◆ Capacity Report
- ◆ Trademark Registration Certificate
- ◆ UKR-Sepro
- ◆ XENIC DIESEL OEM Manufacturer Certificate





### ENGINE

Brand		YANGDONG
Model		Y4105D
Engine Type		13 Stroke - Diesel
Spray Pattern		Direct Injection
Suction Type		Natural
Number of Cylinders		4
Cylinder Diameter and Stroke	mm	105x118
Cylinder Volume	L	4,33
Cooling Type		Su Soğutmalı
Compression Ratio		18:01
100% Fuel Consumption at Prime Load	l/h	8,8
75% Fuel Consumption at Prime Load	l/h	6,75
50% Fuel Consumption at Prime Load	l/h	5,58
25% Fuel Consumption at Prime Load	l/h	4,17
Total Oil Capacity	L	10,46
Total Cooling Capacity	L	10,7
Governor Type	Type	Mechanic



### ALTERNATOR

Brand		Maranello
Model		M44
Output Voltage	V	230/400
Frequency	HZ	50
Automatic Voltage Regulation	±%	1
Standby Power	kVA	42,5
Continuous Use Power	kVA	39
Power Factor	Cosφ	0,8
Number of Cables		12
Winding Pitch		2/12
Protection Class		IP23/H
Warning System		Self-excited
AVR Model		KR620
Performance - PF 0.8 / 75% Load	%	88

### DIMENSIONS

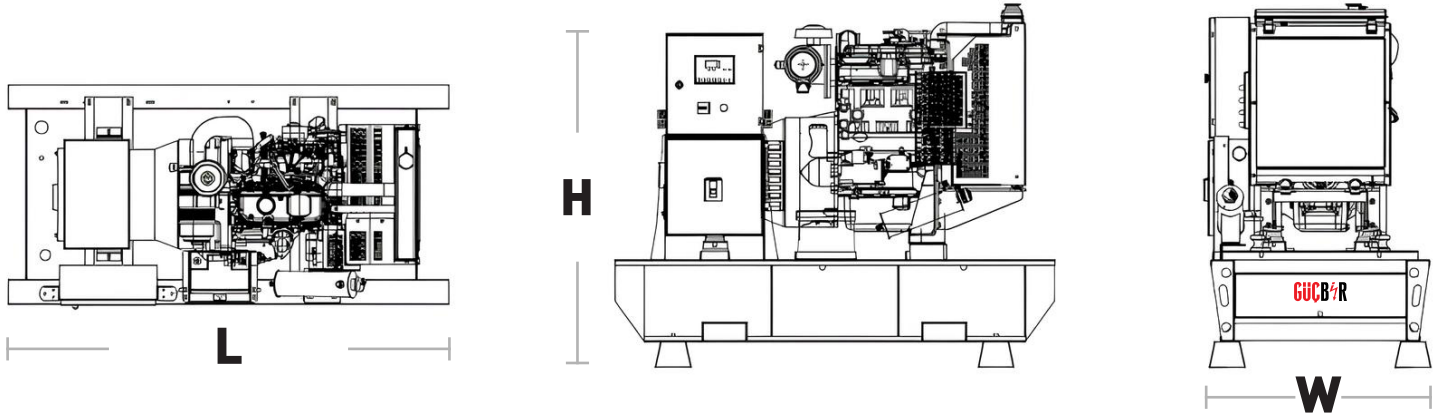

### WITHOUT CABIN

Length (L) x Width (W) x Height (H)	mm	1770x850x1440
Weight	kg	1057
Fuel Tank Capacity	lt	135

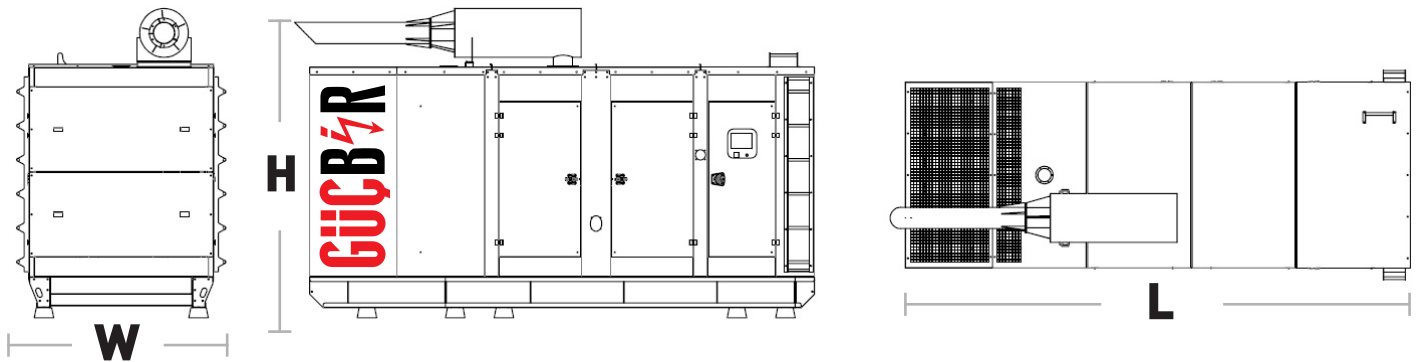

### WITH CANOPY

Length (L) x Width (W) x Height (H)	mm	2225x950x1660
Weight	kg	1092
Fuel Tank Capacity	lt	135

### SOUND ISOLATION CABINET FEATURES

- ◆ Container and modular cabin production
- ◆ 65-75db. sound insulation
- ◆ Anti-vibration system
- ◆ Grilles for cooling and air circulation
- ◆ Special attachments for easy transportation
- ◆ Insulated transparent cover for easy access to the control cabinet
- ◆ Hidden exhaust
- ◆ Emergency stop button

### CONTROL PANEL



### D500 MK3



- ◆ 4-band GPRS modem (optional)
- ◆ USB Device
- ◆ RS-232 (2400-57600baud)
- ◆ J1939-CANBUS
- ◆ Geolocation with GSM
- ◆ GPS support (RS-232)

- ◆ Internet Centric Monitoring
- ◆ Send SMS messages (optional)
- ◆ Emailing (optional) Free PC software
- ◆ re: Rainbow Plu
- ◆ Modbus RTU

### ATS PANEL

Güçbir Generator offers robust, versatile and compact solutions to transfer basic loads and electrical distribution systems from one power source to another with ATS panels. Güçbir's contactors, motorized switches and changeoverbased ATSs range from 40A to 6300 A and can be supplied externally for various applications. Also available internally switchgear inside the ATS panels, which can be supplied by ABB, SIEMENS, SCHNEIDER, GE, LS, HYUNDAI, TELERGON, SOCOMEC and ANDELI are internationally recognized trademarks.



### OPTIONAL FEATURES

- ◆ Medium voltage alternator,
- ◆ Remote radiator applications
- ◆ Automatic refueling system
- ◆ Fuel tank, oil pan, instrument panel, alternator, coil heaters,
- ◆ Alternator with dual AVR and PMG
- ◆ Synchronization systems, Generator output switch,
- ◆ Mains-Generator transfer switches,
- ◆ Cabins in volumes suitable for special insulation demands
- ◆ Seismic solutions
- ◆ Trailer
- ◆ Remote monitoring
- ◆ SMPS 12/24V 10A

### CONTROL PANEL

- ◆ Deepsea Control Devices
- ◆ Emko Control Devices
- ◆ ComAp Control Devices
- ◆ DEIF Control Devices

